



Standard Canopy

STANDARD CONSTRUCTION

- Material: Extruded Aluminum 6063-T6 and/or 6061-T6, Sheet Aluminum 3000 and/or 5000 Series
- Fascia: Rectangular Tube, 0.125" (3.2mm) nominal wall thickness
- Panel Supports: 2" x 2" square tube, 0.125" (3.2mm) nominal wall thickness
- Panels: Aluminum Sheeting, 0.125" (3.2mm) nominal thickness
- Outriggers: Flat Bar, .25" (6.4mm) or .375" (9.5mm) nominal wall thickness
- Mounting Brackets: Extruded Aluminum Tee
- Suspension Rods: 3/4" diameter aluminum rod w/ clevis ends
- Finish: Mill

OPTIONAL ACCESSORIES

- Segmented or radius formed components
- All sizes are custom fabricated to meet project requirements

FINISHES

- 2 coat fluoropolymer: Kynar® 500 / Hylar® 5000 custom colors available in 70% PVDF (AAMA 2605) or 50% PVDF (AAMA 2604) formulas.
- 3 coat fluoropolymer: Kynar 500 / Hylar 5000 custom colors available in 70% PVDF (AAMA 2605) formulas.
- Anodic finishes: **NOT RECOMMENDED**
- Prime coat
- Mill

SUGGESTED SPECIFICATIONS

General: Furnish and install where indicated on drawings canopy as manufactured by Industrial Louvers, Inc., Delano, MN.

Material: Outriggers shall be fabricated from extruded aluminum flat bar, minimum wall thickness of 0.250". Fascia and panel supports shall be fabricated from extruded aluminum, minimum wall thickness 0.125". Canopy panels shall be fabricated from sheet aluminum, minimum thickness 0.125". Mounting brackets shipped loose.

Canopy shall be installed in accordance with manufacturer's recommended attachment method and in accordance with state and federal building codes.

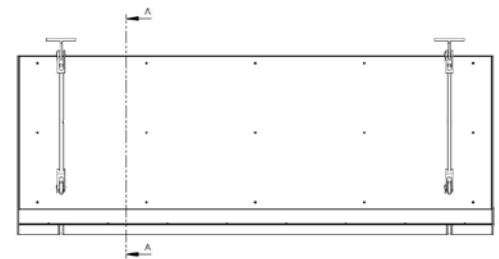
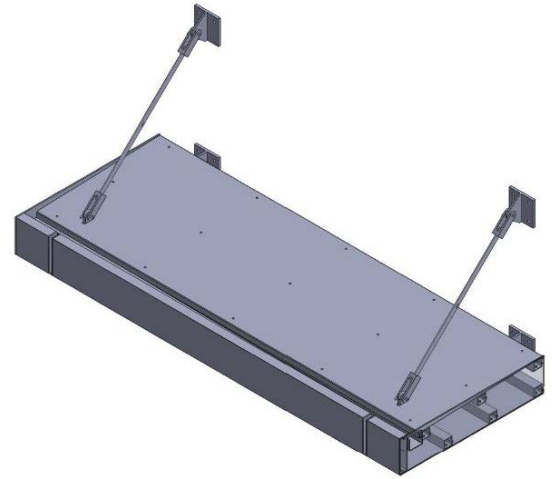

Typical Assembly

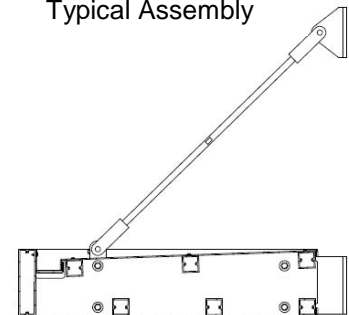

Horizontal Section

Qty.	Size:		M.O. <input type="checkbox"/>	Mullion Type	No. of Sections	Notes
	Width	Actual <input type="checkbox"/> Height				
<input type="checkbox"/>	Sill flashing:			Project:		
<input type="checkbox"/>	Screen:			Location:		
<input type="checkbox"/>	Finish:			Architect:		
	Color:			Representative:		
<input type="checkbox"/>	Other:			Date:	Job #:	

CATALOG NO. Canopy: June 2016

