



Industrial
Louvers, Inc.

www.IndustrialLouvers.com

511 South 7th Street

Delano, MN 55328

763-972-2981

Installation Instructions for Vertical Blade Louvers

Note:

- The information included in the submittal drawing package shall supersede any information included in these installation instructions. Fastener type, size, and quantity shall be dictated by the submittals. It is the responsibility of the installer to follow all building codes and comply with all safety regulations.
- These installation instructions are intended to cover basic louver installation processes. Various surrounding conditions may require a specialized anchorage solution in which case the Industrial Louvers prepared shop drawings should be referenced for installation guidance.
- These installation instructions do not depict louver accessories such as screen or blank off panels. The installation process is similar regardless of accessory type.
- Anchors into substrate are not supplied unless noted otherwise. The installer is responsible for supplying appropriate anchors.
- The product depicted in these installation instructions may not match the product supplied, however the installation process is the same.

Table of Contents

Definitions / Abbreviations	2
Louver Assembly Overview	3
Opening Preparation and Flashing Installation	4
Clip Angle Installation At Sill	5
Clip Angle Installation At Head	6
Louver Unit Installation At Sill	7
Louver Unit Installation At Head	8
Weather Proofing	9

Definitions / Abbreviations

-Blade

The component used to fill the louver area.

-Flashing

Formed metal, peel and stick, or fluid applied membrane intended to divert water to desired location.

-Frame

The component(s) making up the perimeter of the louver.

-Head

The top edge of the louver or opening.

-HWH

Hex Washer Head

-Jamb

The left or right side of the louver assembly.

-Sill

The bottom edge of the louver or opening.

-SM

Sheet Metal.

Louver Assembly Overview

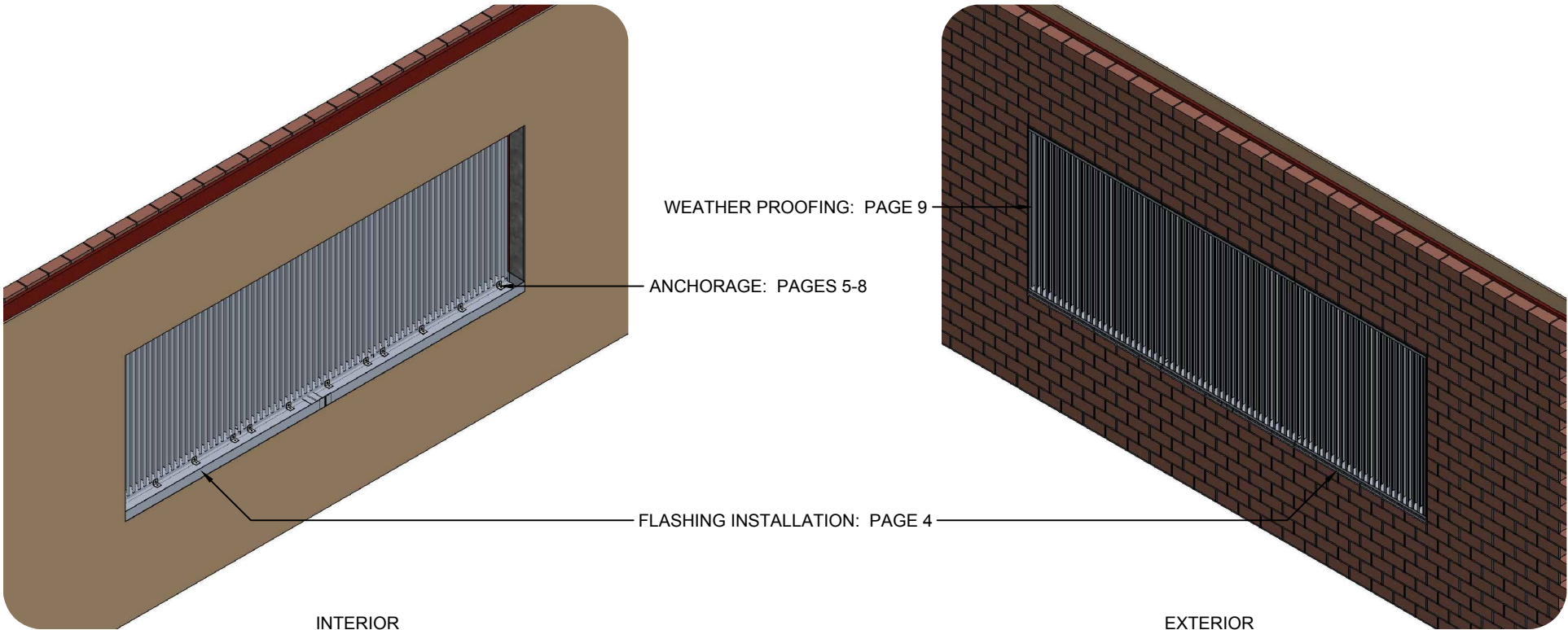

Sill Flashing Installation

1. Inspect opening. Repair any damaged or unsound substrate before proceeding.
2. Apply sealant to opening as necessary to prevent water infiltration between opening and flashing.
3. Set flashing into opening.
4. Set splice cover in a bed of sealant at all sill flashing splice locations.
5. Complete opening preparation by installing additional flashing and sealant as warranted by the wall construction.

Note:

Flashing is not supplied with all louvers. Flashing installation may be omitted, however the opening shall still be properly prepared prior to proceeding.

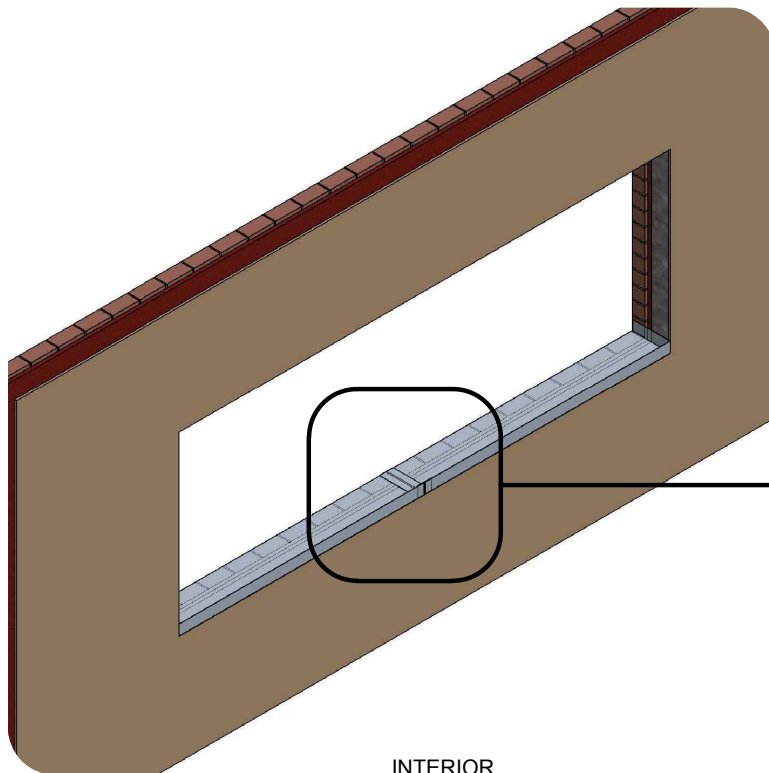

INTERIOR

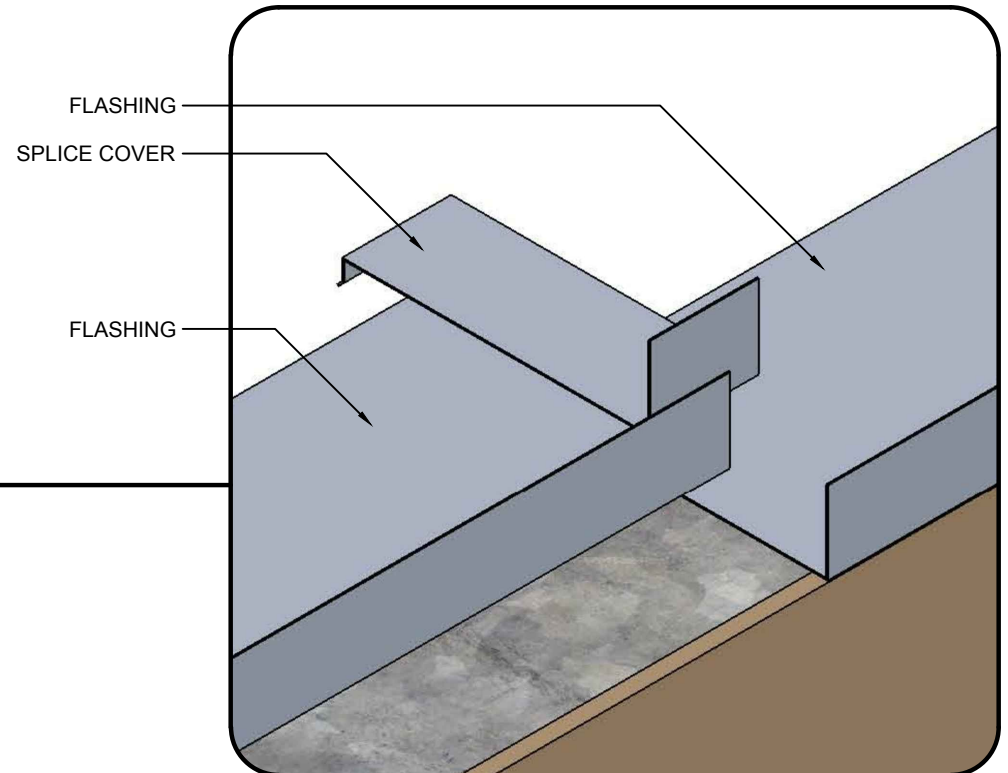

Clip Angle Installation At Sill

1. Mark lateral location of clip angles along the louver bottom frame according to Industrial Louvers prepared shop drawings.
2. At each location marked in step 1 drill 3/16" diameter pilot holes in louver frame for #12 screws.
 - Clip angles shall overhang the bottom of the louver to provide a small gap for water drainage.
3. Fasten clip angles to louver with #12 HWH SM Screws (FAS5135).

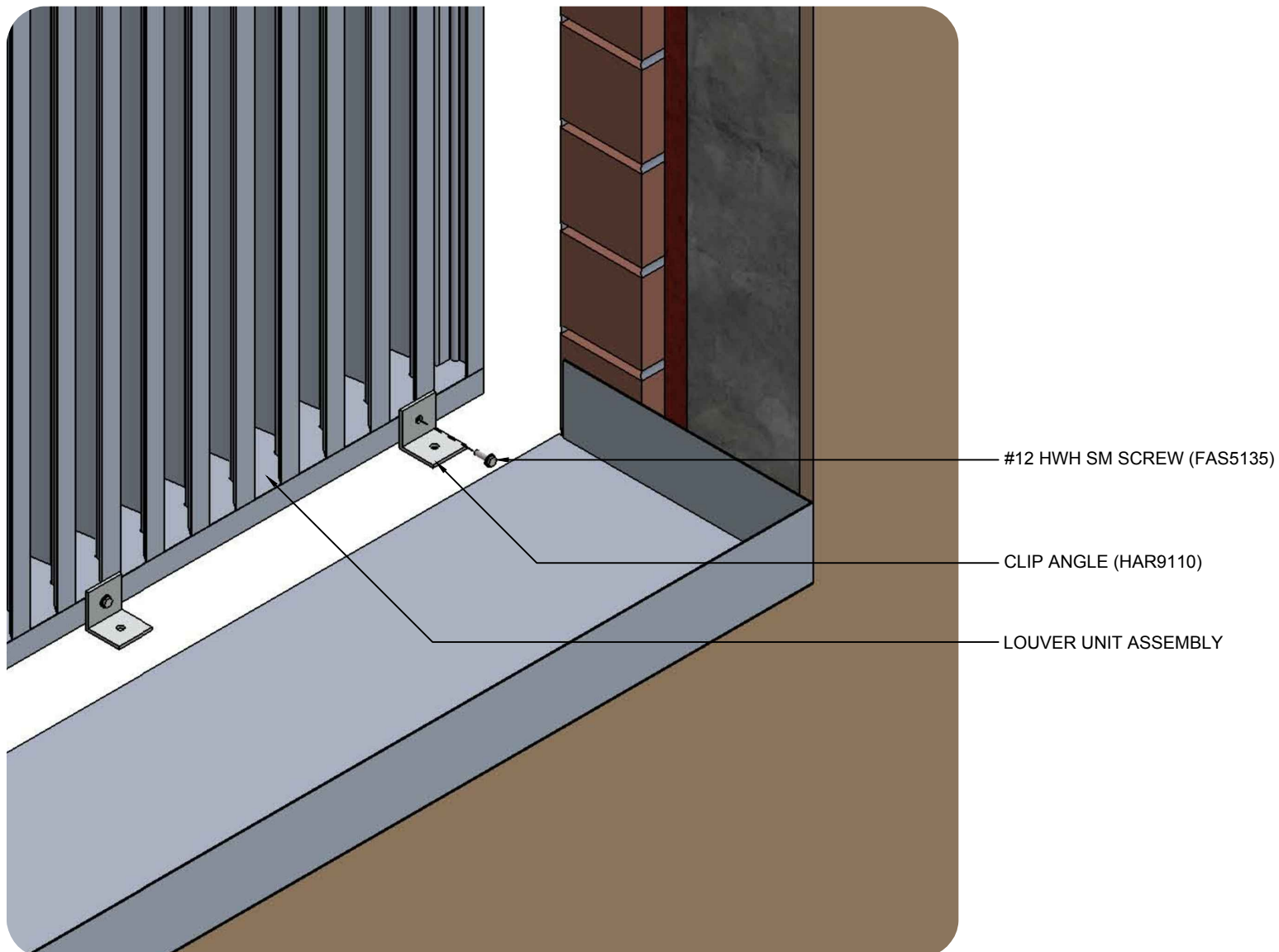

Clip Angle Installation At Head

1. Mark lateral location of clip angles along the opening head according to Industrial Louvers prepared shop drawings.
2. Determine in/out location of clip angles.
 - Consider depth of louver system and any offset required from face of building to face of louver.
3. At each location marked in step 1 mark the in/out clip angle position.
4. Drill pilot holes for anchors.
 - Consult anchor manufacturer's product data for proper substrate preparation.
 - Use clip angles as a template.
5. Install anchors per anchor manufacturer's recommendations.

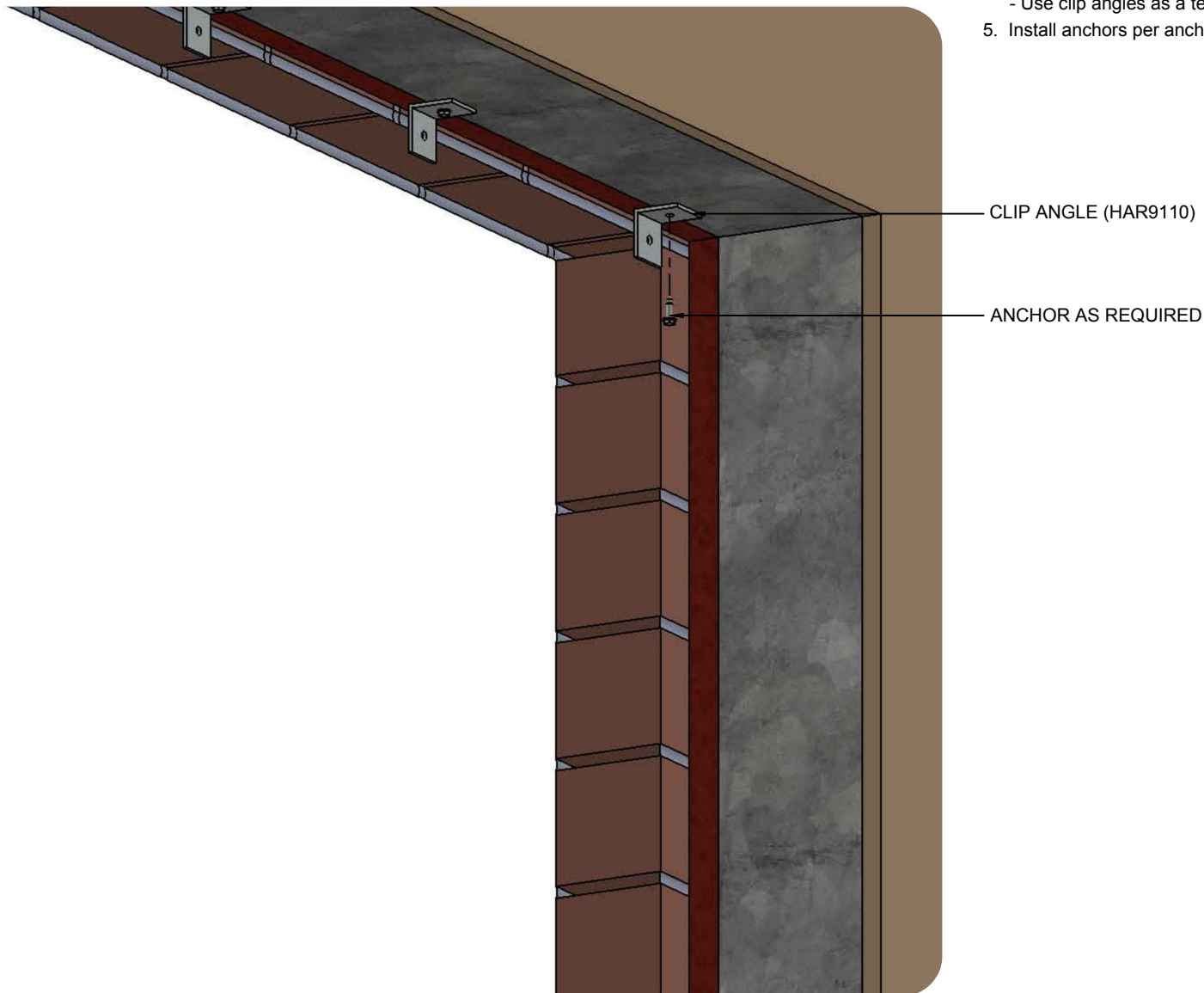

Louver Unit Installation At Sill

1. Place louver unit assembly into position.
 - Confirm sill of louver is properly positioned in/out.
2. At each clip angle drill pilot holes for anchors.
 - Consult anchor manufacturer's product data for proper substrate preparation.
 - Use clip angles as a template.
3. Install anchors per anchor manufacturer's recommendations.
 - All penetrations in sill flashing shall be properly sealed.

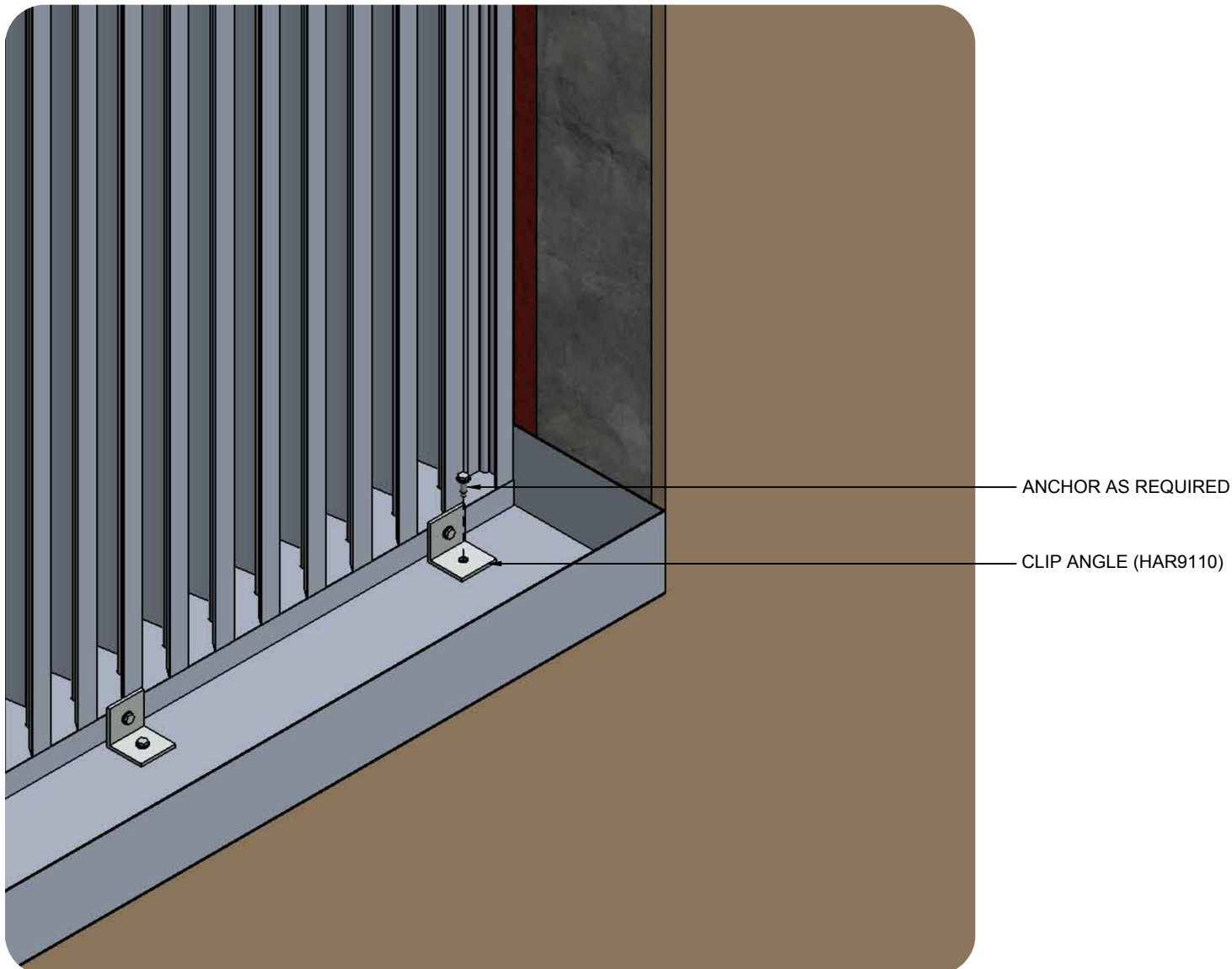

Louver Unit Installation At Head

- 1. Drill 3/16" diameter pilot holes in louver frame for #12 screws.
- 2. Fasten louver to clip angles with #12 HWH SM Screws (FAS5135).
- 3. Repeat steps 2-3 for each clip angle.

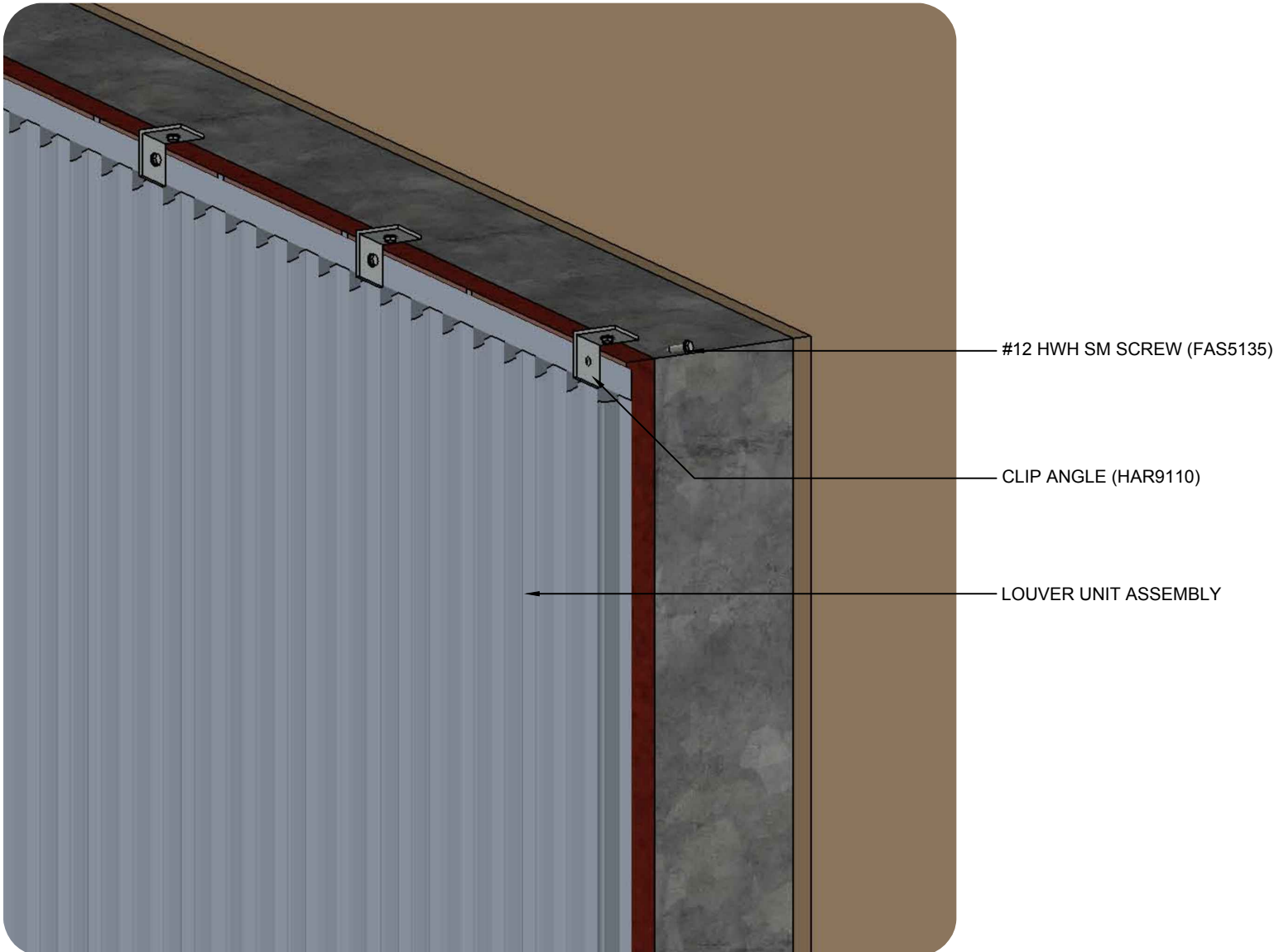

Weather Proofing

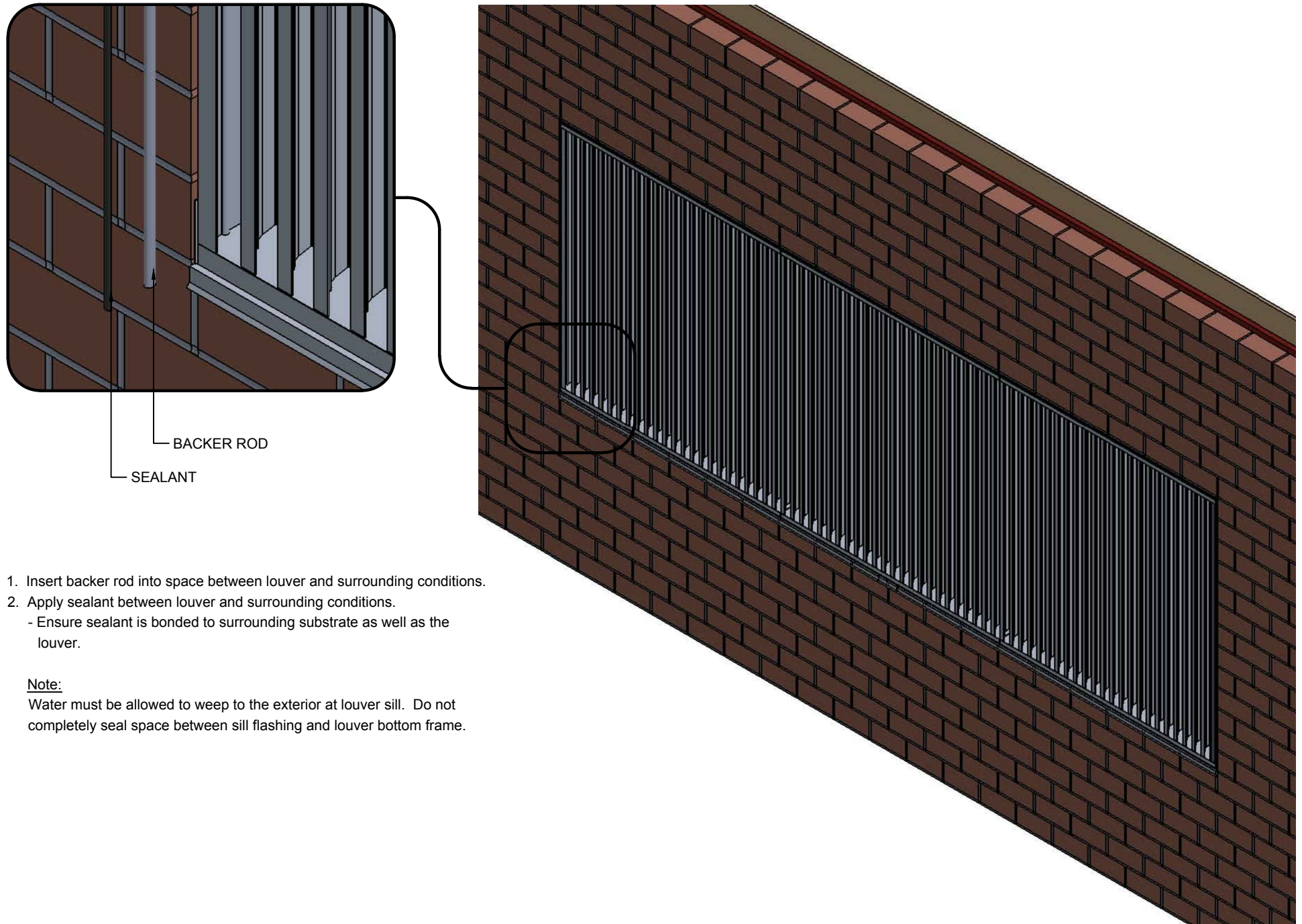

1. Insert backer rod into space between louver and surrounding conditions.
2. Apply sealant between louver and surrounding conditions.
 - Ensure sealant is bonded to surrounding substrate as well as the louver.

Note:

Water must be allowed to weep to the exterior at louver sill. Do not completely seal space between sill flashing and louver bottom frame.